

# Floor Plan

AUGUST 12-13 | 9am-3pm | TRUSTPOWER ARENA **Free entry**

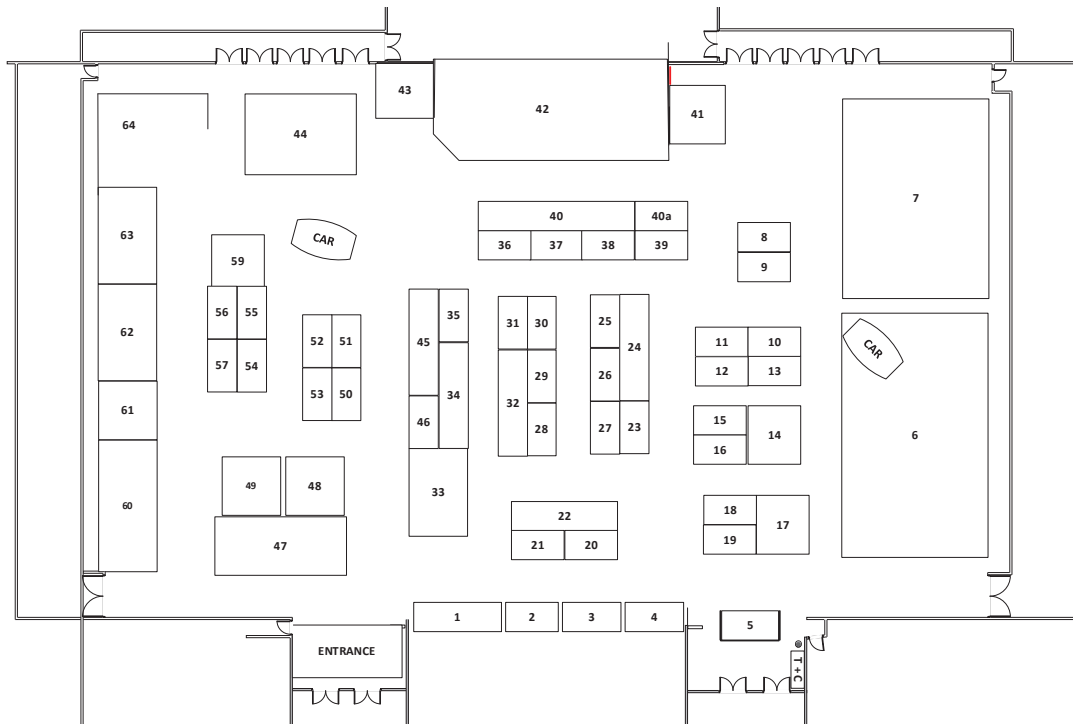

## Exhibition sites

|     |   |    |   |         |   |
|-----|---|----|---|---------|---|
| 32  | Affco Rangioru                                  | 56 | Kia Ora Hauora Te Whatu Ora BOPDHB  | 44      | STEAM-ED (Friday)                                   |
| 35  | AFS Intercultural Programmes                    | 52 | KPMG Accountants  | 44      | STEMFest (Saturday)                                 |
| 34  | AUT   | 28 | McDonald's NZ   | 27      | Talley's  |
| 59  | Ballance Agri-Nutrients                         | 15 | Marine Reach  | 49      | Tauranga City Council                               |
| 21  | Bay Venues                                      | 26 | Massey University   | 57      | Tauranga City Council                               |
| 55  | BCD Group                                       | 16 | Media Design School   | 2       | Tauranga Electoral Office                           |
| 36  | BCITO   | 39 | MSD Studylink   | 41      | Te Wānanga o Aotearoa                               |
| 25  | Bethlehem Tertiary Institute                    | 24 | New Zealand School of Tourism, Elite School of Beauty & Spa and Cut Above Academy | 23      | Te Herenga Waka - Victoria University of Wellington |
| 64  | BOP Film  | 12 | New Zealand College of Chiropractic   | 43      | Te Whare Wānanga o Awanuiārangi                     |
| 40a | BOP Regional Council                            | 60 | New Zealand Defence Force   | 1       | The Rotary Club of Tauranga                         |
| 4   | C3  | 61 | New Zealand Police  | 42      | Toi Kai Rawa  |
| 53  | Chartered Accountants Australia and New Zealand | 63 | NZKGI   | 5       | Toi Ohomai  |
| 38  | Connected                                       | 33 | Pacific Coast Technical Institute   | 6       | Toi Ohomai  |
| 51  | Datacom   | 47 | Page Macrae Engineering   | 17      | Toi Ohomai  |
| 20  | Dive Zone                                       | 8  | Pathways College  | 9       | Tourism Bay of Plenty                               |
| 30  | Downer Group                                    | 11 | PIHMS   | 7       | University of Waikato                               |
| 45  | EmployNZ  | 48 | Priority One, Instep, yia! and Ara Rau  | 31      | Waipapa Taumata Rau University of Auckland          |
| 37  | ETCO  | 10 | Queenstown Resort College   | 13      | Whitecliffe College                                 |
| 62  | Fulton Hogan                                    | 44 | ROBOTICS Competition (Friday)   | 14      | WINTEC  |
| 54  | Grace Hospital                                  | 18 | St George's University  | 22      | Yoobee Colleges                                     |
| 3   | Higgins   | 29 | SIT MAINZ   | Foyer   | Young Enterprise (Saturday)                         |
| 50  | HOBEC Law Firm                                  | 19 | Spirit of Adventure Trust   | Outside | Real Pathways                                       |
| 40  | I and I   | 46 | St John   |         |   |